



Edcarsil Boyce

for Director of Planning and Development

Digitally Signed by Edcarsil Boyce

Email: edcarsil.boyce@planning.gov.bb

Date: Monday, May 13th 2024

Reason: Approval of Certified Surveyor's Plan

Planning and Development Department

Code: LnIZiPim6apSqGpCBVV6lP9bOOMisKkK

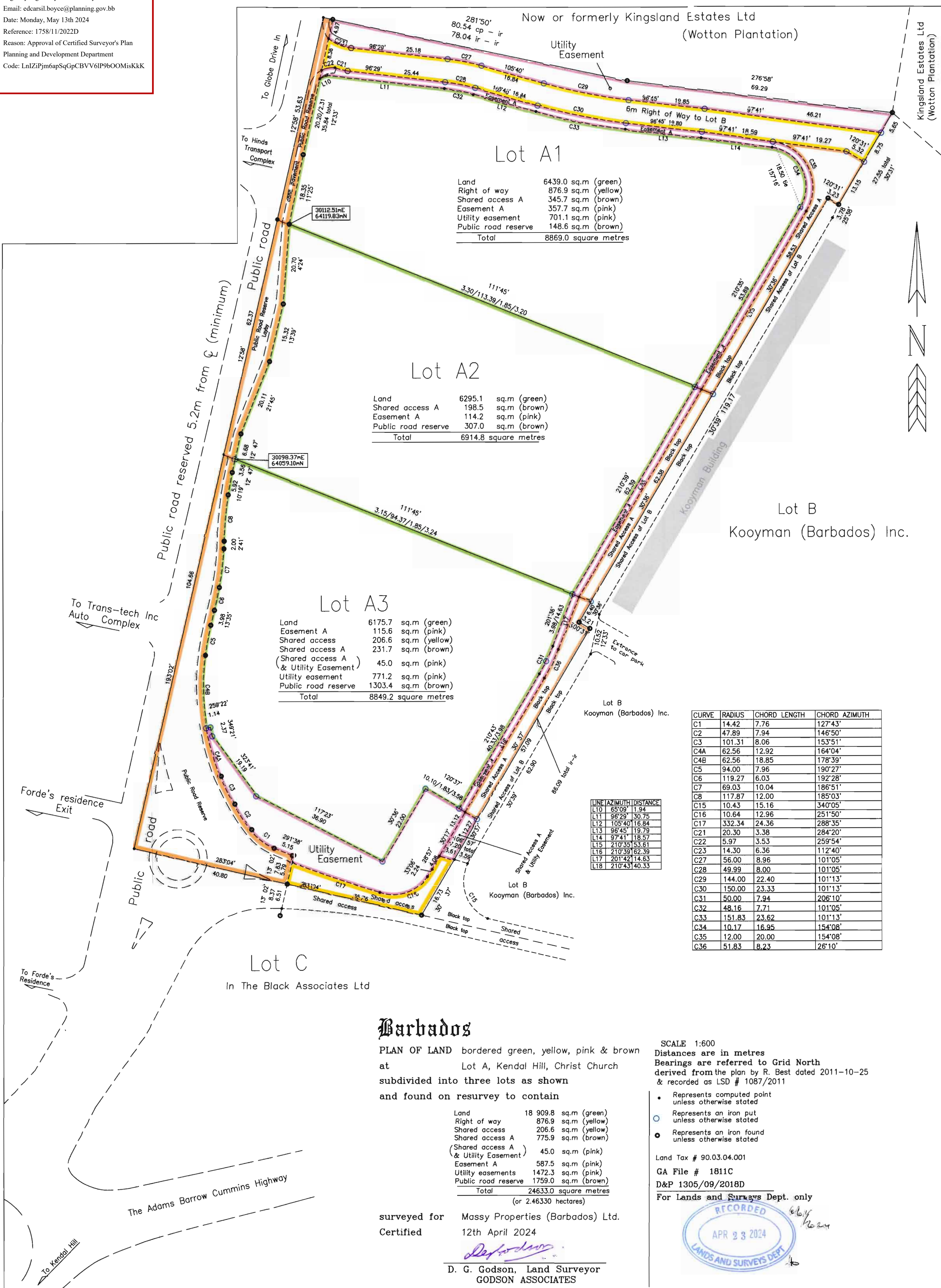

Barbados

PLAN OF LAND bordered green, yellow, pink & brown
at Lot A, Kendal Hill, Christ Church
subdivided into three lots as shown
and found on resurvey to contain

Land	18 909.8	sq.m (green)
Right of way	876.9	sq.m (yellow)
Shared access	206.6	sq.m (yellow)
Shared access A	775.9	sq.m (brown)
(Shared access A & Utility Easement)	45.0	sq.m (pink)
Easement A	587.5	sq.m (pink)
Utility easements	1472.3	sq.m (pink)
Public road reserve	1759.0	sq.m (brown)
Total	24633.0	square metres
	(or 2.46330 hectares)	

surveyed for	Massy Properties (Barbados) Ltd.
Certified	12th April 2024

D. G. Godson, Land Surveyor
GODSON ASSOCIATES

CURVE	RADIUS	CHORD LENGTH	CHORD AZIMUTH
C1	14.42	7.76	127°43'
C2	47.89	7.94	146°50'
C3	101.31	8.06	153°51'
C4	62.56	12.92	164°04'
C4B	62.56	18.85	178°39'
C5	94.00	7.96	190°27'
C6	119.27	6.03	192°28'
C7	69.03	10.04	186°51'
C8	117.87	12.00	185°03'
C15	10.43	15.16	340°05'
C16	10.64	12.96	251°50'
C17	332.34	24.36	288°35'
C21	20.30	3.38	284°20'
C22	5.97	3.53	259°54'
C23	14.30	6.36	112°40'
C27	56.00	8.96	101°05'
C28	49.99	8.00	101°05'
C29	144.00	22.40	101°13'
C30	150.00	23.33	101°13'
C31	50.00	7.94	206°10'
C32	48.16	7.71	101°05'
C33	151.83	23.62	101°13'
C34	10.17	16.95	154°08'
C35	12.00	20.00	154°08'
C36	51.83	8.23	26°10'

SCALE 1:600
Distances are in metres
Bearings are referred to Grid North
derived from the plan by R. Best dated 2011-10-25
& recorded as LSD # 1087/2011

- Represents computed point unless otherwise stated
- Represents an iron put unless otherwise stated
- Represents an iron found unless otherwise stated

Land Tax # 90.03.04.001

GA File # 1811C

D&P 1305/09/2018D

For Lands and Surveys Dept. only

